

MAGNUM 3G LARGE BORE d.75-110mm

Series of fittings with internal components mechanically retained together (into the nut) in order to avoid any possible loss when installed, zero interference system to allow the free insertion to polyethylene pipes from d.75 to d.110mm.

“SLIDE & TIGHTEN” EXCLUSIVE EASY INSERTION & HYDRO MECHANICAL SEALING SYSTEM

The **MAGNUM 3G** large bore series combines the **Slide & Tighten** hydro-mechanical sealing system with the special **NUT-IN** solution, which retains the sealing components within the nut. The dynamic sealing system is obtained by the special design of the compression chamber that guarantees a complete absence of interference between the pipe and the sealing gasket.

This technical feature allows the free insertion of pipes and reduces the installation times. Once the pipe is inserted, tightening progressively the ring nut up to the last thread, the pressure bush forces the gasket to its final appropriate compression chamber. When functioning under pressure, the clinching ring detaches from the pressure bush to reach the correct working position even during very critical laying conditions.

MAGNUM 3G system with makes your life easy: no need to dismantle the fitting to install or uninstall, and all the components remains into the nut. Thanks to this high integrity, there are no falling parts from the fitting during the hand managements.

MAGNUM 3G
SYSTEM

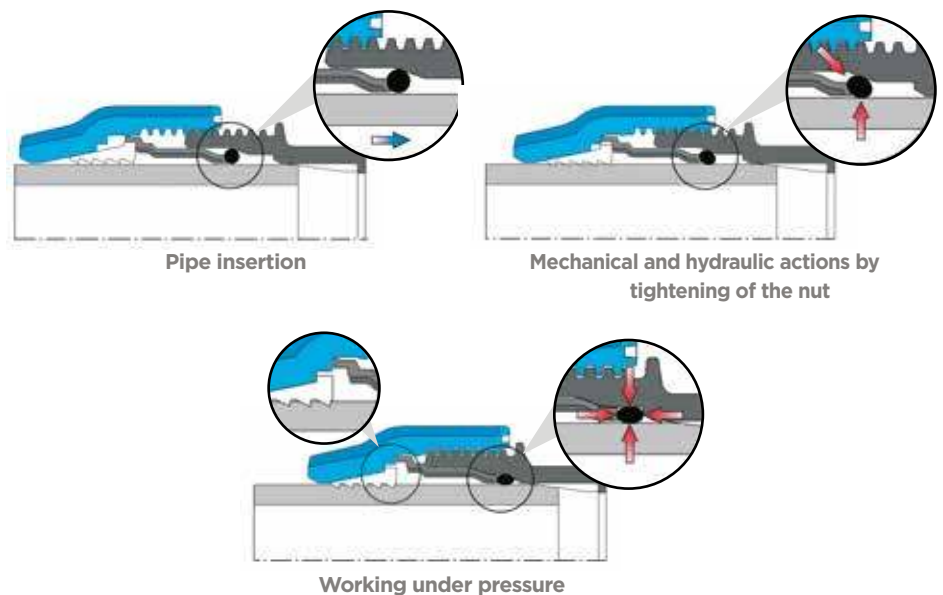

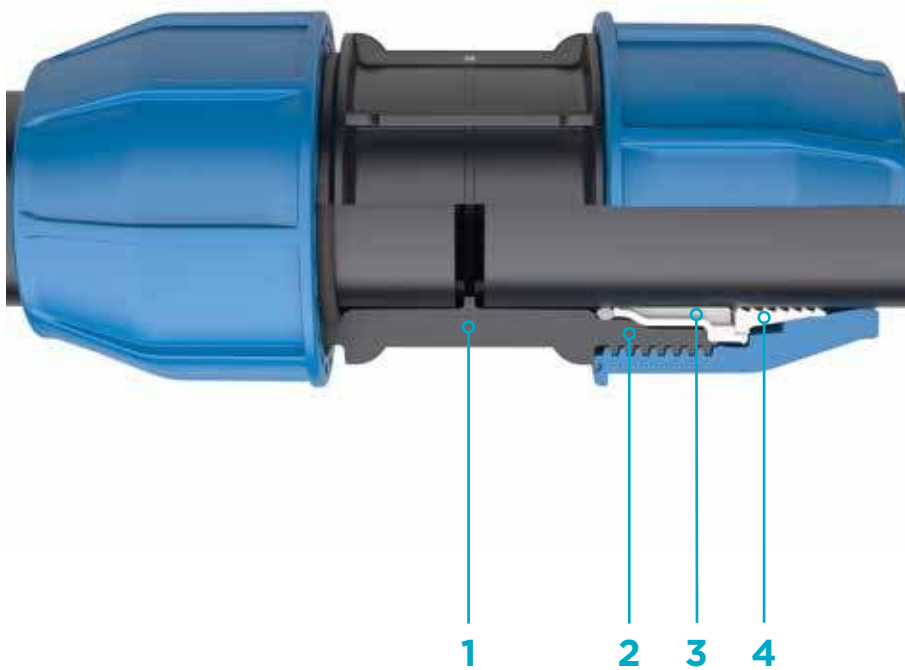

1 BODY IN PP-B

2 COMPRESSION
CHAMBER AND
GASKET

3 PRESSER BUSH IN
PP-B

4 CLINCHING RING
IN POM

MAGNUM 3G d. 16-63 mm

INSTALLATION INSTRUCTIONS

1. Cut Pipe Square

Cut the pipe square. There is no need to prepare the pipe end, check the pipe is free from foreign material or burrs. Chamfering or lubrication is not required.

2. Ready to Use Position

The fitting is pre-assembled and ready to use, however always ensure the nut is fully relaxed, 2 threads are showing before inserting the pipe.

3. Pipe Insertion

Insert the pipe until resistance is felt. Do not force the pipe.

4. Nut Tightening

Tighten the nut by hand and then firmly with a wrench. Tighten the nut until it just touches the body stop end (visual indicator).

5. Check for Correct Installation

Ensure the nut is tighten and no gap exists from the nut end to the compression fitting body stop end (visual indicator). Now the fitting is correctly install. **Make sure do not over tighten nut after reaching the body flange.**

6. Disassembly

To disassemble the fitting, simply loosen the nut using a wrench until 2 threads are showing. Pipe will be free, and can be simply pull out of the fitting.



MAGNUM 3G d. 75-110 mm INSTALLATION INSTRUCTIONS



1. Cut Pipe Square

Clean the pipe end and ensure it is free from burrs. Chamfering or lubrication of pipe is not required.



2. Ready to Use Position

The fitting is pre-assembled and ready to use, however always ensure that 3 threads are showing before proceeding.



3. Witness Mark the Pipe

In the ready to use position lay the pipe against the fitting with the end of the pipe lined up with the flange of the body. Witness mark the section of pipe that is long side the nut opening.



4. Pipe Insertion

Insert the pipe up to the witness mark, or if not using a witness mark until the first point of resistance is felt.



5. Nut Tightening

Tighten the nut by hand and then firmly with a wrench.



6. Fully Installed

Now the fitting is correctly install.

THREADED FITTINGS INSTALLATION INSTRUCTIONS

MAGNUM 3G compression fittings offers a range of advantages over metal threaded fittings

- **Faster, Easier and Reliable Installation.**
- **Less Effort through lower friction**
- **Exploits the properties of Polypropylene to reduce the installation effort compared to metal threads**

MAGNUM 3G threaded fitting bodies are molded with high performance engineering plastic material, which delivers significant benefits.

Less Friction

MAGNUM 3G threaded fittings require significantly less effort to install. The use of high performance plastic that provide far less friction than metal/metal threads.

New Approach to Installation

MAGNUM 3G fittings drives in a new era of threaded connection. The high performance materials conform to slight irregularities in metal threads, whereas metal/metal connections tend to bind themselves by increasing the installation effort.

Smaller Lighter tools

A simple set of multi-grip pliers has be used to install a **MAGNUM 3G** threaded fitting. No need to use a large wrench to install and tighten a threaded fitting.

Proven Performance

MAGNUM 3G threaded fittings are built tough and are used worldwide by water companies, civil contractors, plumbers and in irrigation applications.

Example - Male Adapter into a metal valve

1. Apply PTFE tape or suitable sealant to the plastic thread a quantity to ensure a watertight seal.
2. Using hand, screw the thread of the Male Adapter into the valve until firm.
3. Grip the body of the **MAGNUM 3G** fitting with Multi-grips or similar plumbing tools and continue to screw the male adapter into the valve until tight. Stop if the shoulder of the **MAGNUM 3G** fittings touches the valve.

Note: It is recommend the use of PTFE tape on threads to ensure a positive seal. If a liquid or paste sealant is used, ensure it is suitable to be use with material of **MAGNUM 3G** and the material connected to the fitting.



DIMENSIONS

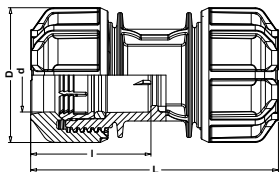

3GZBP

COUPLING

| d | Code | DIMENSIONS | | | Box qty | Bag qty |
|-----|-----------------|------------|-------|------|---------|---------|
| | | D | L | l | | |
| 16 | 3GZBP016 | 39,5 | 75 | 36,2 | 80 | 10 |
| 20 | 3GZBP020 | 46,5 | 89 | 43,4 | 150 | 10 |
| 25 | 3GZBP025 | 55 | 94 | 45,7 | 100 | 10 |
| 32 | 3GZBP032 | 67 | 117,6 | 57,5 | 65 | 5 |
| 40 | 3GZBP040 | 82 | 139 | 67 | 35 | - |
| 50 | 3GZBP050 | 94 | 160,6 | 79 | 24 | - |
| 63 | 3GZBP063 | 109 | 187 | 90,5 | 12 | - |
| 75 | ZBP075 | 135 | 298 | 147 | 12 | - |
| 90 | ZBP090 | 158 | 359 | 177 | 8 | - |
| 110 | ZBP110 | 191 | 425,5 | 210 | 4 | - |

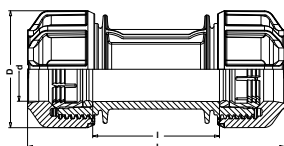

3GZRP

SLIP COUPLING

| d | Code | DIMENSIONS | | | Box qty | Bag qty |
|----|-----------------|------------|-------|-------|---------|---------|
| | | D | L | l | | |
| 20 | 3GZRP020 | 46,5 | 103,5 | 45,6 | 130 | 10 |
| 25 | 3GZRP025 | 55 | 121 | 51,3 | 70 | 10 |
| 32 | 3GZRP032 | 67 | 153,6 | 71,4 | 60 | 5 |
| 40 | 3GZRP040 | 82 | 188,5 | 97 | 30 | - |
| 50 | 3GZRP050 | 94 | 205 | 100,2 | 20 | - |
| 63 | 3GZRP063 | 109 | 221 | 106 | 12 | - |

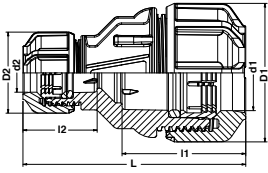

3GZBRP

REDUCING COUPLING

| d1 | d2 | Code | DIMENSIONS | | | | | Box qty | Bag qty |
|-----|----|---------------------|------------|------|-------|-----|-----|---------|---------|
| | | | D1 | D2 | L | l1 | l2 | | |
| 20 | 16 | 3GZBRP020016 | 46,5 | 39,5 | 83 | 46 | 38 | 80 | 10 |
| 25 | 16 | 3GZBRP025016 | 55 | 39,5 | 87 | 51 | 38 | 120 | 10 |
| 25 | 20 | 3GZBRP025020 | 55 | 46,5 | 94 | 51 | 46 | 120 | 10 |
| 32 | 20 | 3GZBRP032020 | 67 | 46,5 | 110 | 60 | 46 | 80 | 5 |
| 32 | 25 | 3GZBRP032025 | 67 | 55 | 108 | 60 | 51 | 70 | 5 |
| 40 | 25 | 3GZBRP040025 | 82 | 55 | 125 | 71 | 51 | 50 | - |
| 40 | 32 | 3GZBRP040032 | 82 | 67 | 128 | 71 | 60 | 40 | - |
| 50 | 25 | 3GZBRP050025 | 94 | 55 | 141 | 83 | 51 | 30 | - |
| 50 | 32 | 3GZBRP050032 | 94 | 67 | 150 | 83 | 60 | 30 | - |
| 50 | 40 | 3GZBRP050040 | 94 | 82 | 149 | 83 | 71 | 25 | - |
| 63 | 32 | 3GZBRP063032 | 109 | 67 | 167 | 93 | 60 | 20 | - |
| 63 | 40 | 3GZBRP063040 | 109 | 82 | 173 | 93 | 71 | 18 | - |
| 63 | 50 | 3GZBRP063050 | 109 | 94 | 174 | 93 | 83 | 16 | - |
| 75 | 63 | ZBRP075063 | 135 | 113 | 275 | 147 | 124 | 20 | - |
| 90 | 75 | ZBRP090075 | 158 | 135 | 329 | 177 | 147 | 12 | - |
| 110 | 90 | ZBRP110090 | 191 | 158 | 392,5 | 210 | 177 | 6 | - |

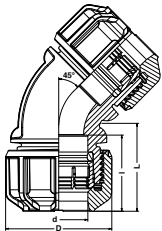

3GZHP

45° ELBOW

| d | Code | DIMENSIONS | | | Box qty | Bag qty |
|----|-----------------|------------|----|----|---------|---------|
| | | D | L | l | | |
| 32 | 3GZHP032 | 67 | 53 | 52 | 20 | 5 |
| 40 | 3GZHP040 | 82 | 67 | 66 | 15 | - |
| 50 | 3GZHP050 | 94 | 81 | 71 | 20 | - |
| 63 | 3GZHP063 | 109 | 97 | 82 | 12 | - |

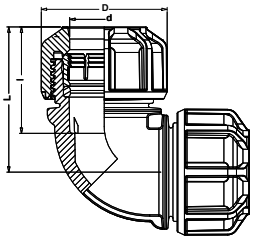

3GZGP

90° ELBOW

| d | Code | DIMENSIONS | | | Box qty | Bag qty |
|-----|-----------------|------------|-------|------|---------|---------|
| | | D | L | I | | |
| 16 | 3GZGP016 | 39,5 | 51 | 38,5 | 80 | 10 |
| 20 | 3GZGP020 | 46,5 | 57 | 44,5 | 140 | 10 |
| 25 | 3GZGP025 | 55 | 66,5 | 49,5 | 90 | 10 |
| 32 | 3GZGP032 | 67 | 77 | 58 | 50 | 5 |
| 40 | 3GZGP040 | 82 | 91 | 71 | 30 | - |
| 50 | 3GZGP050 | 94 | 102,5 | 76 | 18 | - |
| 63 | 3GZGP063 | 109 | 119,5 | 88,5 | 10 | - |
| 75 | ZGP075 | 135 | 191 | 147 | 12 | - |
| 90 | ZGP090 | 158 | 227 | 177 | 5 | - |
| 110 | ZGP110 | 191 | 270,5 | 210 | 4 | - |

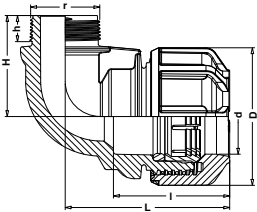

3GZGMP

MALE THREADED 90° ELBOW

| d | r | Code | DIMENSIONS | | | | | Box qty | Bag qty |
|----|-------|---------------------|------------|-------|------|------|------|---------|---------|
| | | | D | L | I | H | h | | |
| 16 | 1/2 | 3GZGMP016012 | 39,5 | 50,8 | 38 | 37,3 | 16,8 | 80 | 10 |
| 20 | 1/2 | 3GZGMP020012 | 46,5 | 58,7 | 43,9 | 38,8 | 16,8 | 220 | 10 |
| 20 | 3/4 | 3GZGMP020034 | 46,5 | 58,7 | 43,9 | 62,8 | 16,8 | 190 | 10 |
| 25 | 1/2 | 3GZGMP025012 | 55 | 64,7 | 49,7 | 43,4 | 16,8 | 150 | 10 |
| 25 | 3/4 | 3GZGMP025034 | 55 | 65,6 | 49,7 | 43,4 | 16,8 | 120 | 10 |
| 25 | 1 | 3GZGMP025100 | 55 | 67,8 | 49 | 50,1 | 19,4 | 110 | 10 |
| 32 | 3/4 | 3GZGMP032034 | 67 | 80,2 | 57,9 | 48,9 | 16,6 | 75 | 5 |
| 32 | 1 | 3GZGMP032100 | 67 | 80,2 | 58,4 | 51,4 | 18,4 | 75 | 5 |
| 32 | 1 1/4 | 3GZGMP032114 | 67 | 82 | 58,7 | 54,7 | 20,5 | 75 | 5 |
| 40 | 1 | 3GZGMP040100 | 82 | 95,8 | 67,6 | 58,6 | 18,4 | 45 | - |
| 40 | 1 1/4 | 3GZGMP040114 | 82 | 96,4 | 68,6 | 60,9 | 20,7 | 45 | - |
| 50 | 1 1/4 | 3GZGMP050114 | 94 | 111,2 | 79,2 | 68 | 21 | 30 | - |
| 50 | 1 1/2 | 3GZGMP050112 | 94 | 112 | 79,2 | 68 | 21 | 30 | - |
| 63 | 2 | 3GZGMP063200 | 109 | 129,5 | 88,8 | 79,5 | 24,5 | 18 | - |

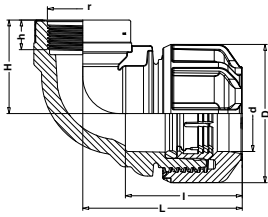

3GZGFP / 3GZGFKP

90° ELBOW FEMALE THREADED

| d (mm) | r (inches) | Code | DIMENSIONS | | | | | Box qty | Bag qty |
|--------|------------|----------------------|------------|-------|------|------|------|---------|---------|
| | | | D | L | I | H | h | | |
| 16 | 1/2" | 3GZGFP016012 | 39,5 | 51 | 38 | 67 | 22,8 | 80 | 10 |
| 20 | 1/2 | 3GZGFP020012 | 46,5 | 58,8 | 40,6 | 32,8 | 17,7 | 230 | 10 |
| 20 | 3/4 | 3GZGFP020034 | 46,5 | 58,8 | 40,6 | 34,5 | 18,4 | 190 | 10 |
| 25 | 1/2 | 3GZGFP025012 | 55 | 70,4 | 50,5 | 34,9 | 17,6 | 150 | 10 |
| 25 | 3/4 | 3GZGFP025034 | 55 | 70,4 | 50,5 | 36,8 | 17,6 | 120 | 10 |
| 25 | 1 | 3GZGFP025100 | 55 | 70,4 | 50,5 | 42,3 | 21 | 110 | 10 |
| 32 | 3/4 | 3GZGFP032034 | 67 | 82,6 | 58 | 41,7 | 17,7 | 75 | 5 |
| 32 | 1 | 3GZGFP032100 | 67 | 81,8 | 58 | 44,1 | 20,9 | 75 | 5 |
| 32 | 1 1/4 | 3GZGFKP032114 | 67 | 82,8 | 58 | 48,7 | 23,6 | 75 | 5 |
| 40 | 1 | 3GZGFP040100 | 82 | 98,1 | 70,2 | 49,8 | 21 | 45 | - |
| 40 | 1 1/4 | 3GZGFKP040114 | 82 | 97,4 | 70,2 | 52,1 | 23,3 | 45 | - |
| 50 | 1 1/4 | 3GZGFKP050114 | 94 | 106,7 | 78,5 | 61,5 | 23,3 | 30 | - |
| 50 | 1 1/2 | 3GZGFKP050112 | 94 | 107,6 | 78,5 | 61,5 | 23,3 | 30 | - |
| 50 | 2 | 3GZGFKP050200 | 94 | 106 | 83 | 142 | 34,5 | 26 | - |
| 63 | 2 | 3GZGFKP063200 | 109 | 119,8 | 85,4 | 77,5 | 28 | 18 | - |
| 75 | 2 | ZGFP075200 | 135 | 191 | 147 | 99 | 32,5 | 20 | - |
| 75 | 2 1/2 | ZGFP075212 | 135 | 191 | 147 | 99 | 32,5 | 14 | - |
| 75 | 3 | ZGFP075300 | 135 | 191 | 147 | 129 | 36,5 | 14 | - |
| 90 | 3 | ZGFP090300 | 158 | 158 | 177 | 123 | 36,5 | 10 | - |
| 110 | 4 | ZGFP110300 | 191 | 191 | 210 | 144 | 43,5 | 6 | - |

From r.1 1/4" to 4" provided of stainless steel reinforcing ring as standard, available on request the whole range with or without reinforcing ring

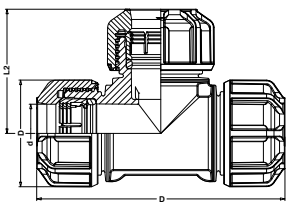

3GZTP

TEE 90°

| d | Code | DIMENSIONS | | | | Box qty | Bag qty |
|-----|-----------------|------------|-------|------|------|---------|---------|
| | | D | L | L2 | I | | |
| 16 | 3GZTP016 | 39,5 | 102 | 51 | 36 | 50 | 10 |
| 20 | 3GZTP020 | 46,5 | 117,5 | 58,3 | 44 | 90 | 10 |
| 25 | 3GZTP025 | 55 | 130,7 | 63,8 | 48,2 | 50 | 10 |
| 32 | 3GZTP032 | 67 | 154,3 | 78,4 | 57,4 | 30 | 5 |
| 40 | 3GZTP040 | 82 | 184,5 | 93,1 | 65,3 | 18 | - |
| 50 | 3GZTP050 | 84 | 210 | 104 | 75 | 12 | - |
| 63 | 3GZTP063 | 109 | 242 | 115 | 82,7 | 8 | - |
| 75 | ZTP075 | 135 | 382 | 188 | 147 | 6 | - |
| 90 | ZTP090 | 158 | 454 | 226 | 177 | 3 | - |
| 110 | ZTP110 | 191 | 541 | 276 | 210 | 2 | - |

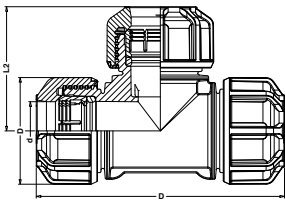

3GZTRRP

SLIP TEE 90°

| d | Code | DIMENSIONS | | | Box qty | Bag qty |
|----|-------------------|------------|-----|-----|---------|---------|
| | | D | L | L2 | | |
| 20 | 3GZTRRP020 | 46,5 | 117 | 59 | 90 | 10 |
| 25 | 3GZTRRP025 | 55 | 134 | 67 | 50 | 10 |
| 32 | 3GZTRRP032 | 67 | 160 | 80 | 25 | 5 |
| 40 | 3GZTRRP040 | 82 | 182 | 95 | 18 | - |
| 50 | 3GZTRRP050 | 84 | 202 | 101 | 10 | - |
| 63 | 3GZTRRP063 | 109 | 236 | 118 | 7 | - |

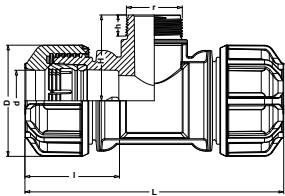

3GZTMP

TEE 90° MALE THREADED

| d | r | Code | DIMENSIONS | | | | | Box qty | Bag qty |
|----|-------|---------------------|------------|-------|------|------|------|---------|---------|
| | | | D | L | l | H | h | | |
| 25 | 1/2 | 3GZTMP025012 | 55 | 114 | 39,5 | 53 | 19,8 | 80 | 10 |
| 25 | 3/4 | 3GZTMP025034 | 55 | 114 | 39,5 | 54 | 21,1 | 75 | 5 |
| 32 | 1 | 3GZTMP032100 | 67 | 158,5 | 60 | 54,4 | 18,6 | 50 | - |
| 40 | 1 1/4 | 3GZTMP040114 | 82 | 191 | 68 | 63,4 | 19,5 | 25 | - |
| 50 | 1 1/2 | 3GZTMP050112 | 94 | 218 | 79 | 72 | 19,5 | 18 | - |
| 63 | 2 | 3GZTMP063200 | 109 | 245 | 85 | 86,5 | 21,9 | 10 | - |

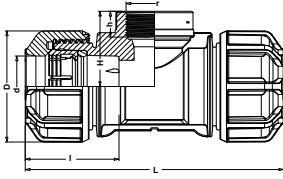

3GZTFP / 3GZTFKP

TEE 90° FEMALE THREADED

| d | r | Code | DIMENSIONS | | | | | | Box qty | Bag qty |
|-----|-------|---------------|------------|-----|------|-------|------|-----|---------|---------|
| | | | D | L | l | H | h | | | |
| 16 | 1/2 | 3GZTFP016012 | 39,5 | 102 | 36 | 33 | 22,8 | 60 | 10 | |
| 20 | 1/2 | 3GZTFP020012 | 46,5 | 120 | 44,8 | 31,8 | 17,4 | 110 | 10 | |
| 20 | 3/4 | 3GZTFP020034 | 46,5 | 120 | 44,8 | 34,8 | 17,6 | 110 | 10 | |
| 25 | 1/2 | 3GZTFP025012 | 55 | 134 | 50,6 | 37,5 | 17,5 | 70 | 10 | |
| 25 | 3/4 | 3GZTFP025034 | 55 | 134 | 50,6 | 37,5 | 17,7 | 60 | 10 | |
| 25 | 1 | 3GZTFP025100 | 55 | 134 | 50,6 | 43 | 20,7 | 60 | 10 | |
| 32 | 3/4 | 3GZTFP032034 | 67 | 162 | 60 | 43,3 | 17,5 | 45 | 5 | |
| 32 | 1 | 3GZTFP032100 | 67 | 162 | 60 | 46,9 | 20,9 | 40 | 5 | |
| 32 | 1 1/4 | 3GZTFKP032114 | 67 | 162 | 60 | 49,9 | 23 | 40 | 5 | |
| 40 | 1 | 3GZTFP040100 | 82 | 192 | 68,3 | 53 | 21 | 20 | - | |
| 40 | 1 1/4 | 3GZTFKP040114 | 82 | 192 | 68,3 | 53 | 23,5 | 20 | - | |
| 50 | 1 1/4 | 3GZTFKP050114 | 94 | 218 | 79 | 60,5 | 23,6 | 15 | - | |
| 50 | 1 1/2 | 3GZTFKP050112 | 94 | 218 | 79 | 62,5 | 23,6 | 15 | - | |
| 63 | 2 | 3GZTFKP063200 | 109 | 241 | 84,8 | 76,5 | 27,6 | 9 | - | |
| 75 | 2 | ZTFP075200 | 135 | 382 | 147 | 76,5 | 32,5 | 8 | - | |
| 75 | 2 1/2 | ZTFP075212 | 135 | 382 | 147 | 76 | 32,5 | 8 | - | |
| 75 | 3 | ZTFP075300 | 135 | 382 | 147 | 92,5 | 36,5 | 8 | - | |
| 90 | 3 | ZTFP090300 | 158 | 454 | 177 | 86,5 | 36,5 | 4 | - | |
| 110 | 4 | ZTFP110400 | 191 | 541 | 210 | 101,5 | 43,5 | 3 | - | |

From r1 1/4" to 4" provided of stainless steel reinforcing ring as standard, available on request the whole range with or without reinforcing ring

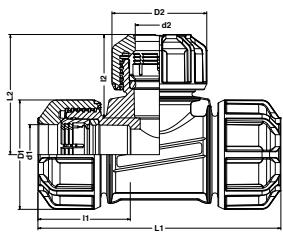

3GZTRP

REDUCING TEE 90°

| d1 | d2 | Code | DIMENSIONS | | | | | | | Box qty | Bag qty |
|----|----|--------------|------------|-----|----|----|-----|------|----|---------|---------|
| | | | D1 | L1 | l1 | D2 | L2 | l2 | | | |
| 25 | 20 | 3GZTRP025020 | 55 | 134 | 50 | 47 | 64 | 45,5 | 60 | 10 | |
| 25 | 32 | 3GZTRP025032 | 55 | 134 | 50 | 67 | 69 | 62 | 55 | 5 | |
| 32 | 25 | 3GZTRP032025 | 67 | 160 | 60 | 55 | 74 | 51 | 35 | 5 | |
| 40 | 25 | 3GZTRP040025 | 81 | 166 | 71 | 55 | 74 | 51 | 20 | - | |
| 40 | 32 | 3GZTRP040032 | 81 | 171 | 71 | 67 | 84 | 60 | 20 | - | |
| 50 | 25 | 3GZTRP050025 | 94 | 182 | 79 | 55 | 81 | 51 | 12 | - | |
| 50 | 32 | 3GZTRP050032 | 94 | 187 | 79 | 67 | 90 | 63 | 12 | - | |
| 50 | 40 | 3GZTRP050040 | 94 | 197 | 79 | 81 | 98 | 71 | 12 | - | |
| 63 | 25 | 3GZTRP063025 | 110 | 196 | 88 | 55 | 88 | 51 | 9 | - | |
| 63 | 32 | 3GZTRP063032 | 110 | 201 | 88 | 67 | 98 | 59 | 9 | - | |
| 63 | 50 | 3GZTRP063050 | 110 | 220 | 88 | 94 | 111 | 79 | 9 | - | |

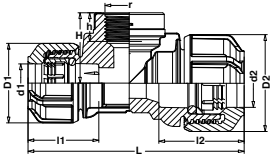

3GZTFP

TEE 90° FEMALE THREADED

| d1 | r | d2 | Code | DIMENSIONS | | | | | | Box qty | Bag qty | |
|----|---|----|-----------------------|------------|----|-----|------|----|----|---------|---------|----|
| | | | | D1 | D2 | L | l1 | l2 | H | | | h |
| 25 | 1 | 32 | 3GZTFP03210005 | 55 | 67 | 152 | 50,3 | 60 | 48 | 20,2 | 60 | 10 |

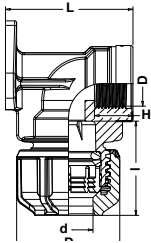

3GZWFP

WALL PLATE ELBOW 90°

| d | r | Code | DIMENSIONS | | | | Box qty | Bag qty |
|----|------|---------------------|------------|----|------|------|---------|---------|
| | | | D | L | l | h | | |
| 20 | 1/2" | 3GZWFP020012 | 46,5 | 56 | 44,5 | 20,8 | 230 | 10 |
| 25 | 3/4" | 3GZWFP025034 | 55 | 65 | 51,2 | 20,8 | 120 | 10 |

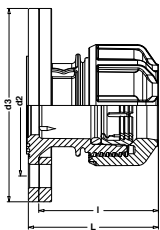

3GZOP

FLANGED ADAPTOR

| d1 | DN | Code | DIMENSIONS | | | | | | Box qty | Bag qty |
|-----|-----|--------------------|------------|-------|-------|-------|-----|----|---------|---------|
| | | | D | d2 | d3 | L | l | | | |
| 50 | 40 | 3GZOP050040 | 94 | 109,5 | 149,2 | 102 | 92 | 18 | - | |
| 50 | 50 | 3GZOP050050 | 94 | 124,6 | 164,3 | 102 | 92 | 18 | - | |
| 63 | 50 | 3GZOP063050 | 109 | 124,6 | 164,3 | 112 | 102 | 10 | - | |
| 75 | 75 | ZOP075065 | 75 | 145 | 185 | 165 | 147 | 10 | - | |
| 90 | 80 | ZOP090080 | 90 | 160 | 200 | 197 | 177 | 6 | - | |
| 90 | 100 | ZOP090100 | 90 | 180 | 220 | 198,5 | 177 | 6 | - | |
| 110 | 100 | ZOP110100 | 110 | 180 | 220 | 231 | 210 | 5 | - | |

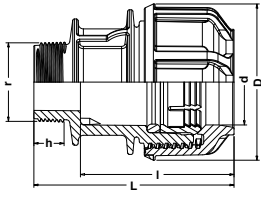

3GZMP

MALE ADAPTOR

| d | r | Code | DIMENSIONS | | | | Box qty | Bag qty |
|-----|-------|--------------------|------------|-------|------|------|---------|---------|
| | | | D | L | l | h | | |
| 16 | 3/8 | 3GZMP016038 | 39,5 | 68 | 44 | 21,1 | 100 | 10 |
| 16 | 1/2 | 3GZMP016012 | 39,5 | 58 | 42,1 | 14,5 | 100 | 10 |
| 16 | 3/4 | 3GZMP016034 | 39,5 | 68 | 44 | 21,1 | 100 | 10 |
| 20 | 1/2 | 3GZMP020012 | 46,5 | 70,4 | 50,1 | 14,5 | 240 | 10 |
| 20 | 3/4 | 3GZMP020034 | 46,5 | 70,4 | 50,1 | 14,5 | 240 | 10 |
| 25 | 1/2 | 3GZMP025012 | 55 | 76,2 | 57,9 | 14,5 | 150 | 10 |
| 25 | 3/4 | 3GZMP025034 | 55 | 78,2 | 57,9 | 14,5 | 150 | 10 |
| 25 | 1 | 3GZMP025100 | 55 | 80,3 | 57,9 | 16,4 | 150 | 10 |
| 32 | 3/4 | 3GZMP032034 | 67 | 88,5 | 66 | 14,5 | 90 | 5 |
| 32 | 1 | 3GZMP032100 | 67 | 90,7 | 66 | 16,4 | 90 | 5 |
| 32 | 1 1/4 | 3GZMP032114 | 67 | 92,4 | 66 | 18,4 | 90 | 5 |
| 32 | 1 1/2 | 3GZMP032112 | 67 | 97 | 67,5 | 26,7 | 85 | 5 |
| 40 | 1 | 3GZMP040100 | 82 | 102,8 | 78,3 | 16,4 | 55 | - |
| 40 | 1 1/4 | 3GZMP040114 | 82 | 104,5 | 78,3 | 18,4 | 55 | - |
| 40 | 1 1/2 | 3GZMP040112 | 82 | 109 | 81 | 26,7 | 55 | - |
| 40 | 2 | 3GZMP040200 | 82 | 109 | 81 | 31 | 50 | - |
| 50 | 1 1/4 | 3GZMP050114 | 94 | 114,2 | 87,2 | 18,4 | 35 | - |
| 50 | 1 1/2 | 3GZMP050112 | 94 | 115 | 87,2 | 19 | 35 | - |
| 50 | 2 | 3GZMP050200 | 94 | 119 | 87,2 | 31 | 32 | - |
| 63 | 1 1/2 | 3GZMP063112 | 109 | 132 | 98,5 | 26,7 | 24 | - |
| 63 | 2 | 3GZMP063200 | 109 | 132 | 97 | 22,9 | 22 | - |
| 75 | 2 | ZMP075200 | 135 | 187 | 147 | 32 | 24 | - |
| 75 | 2 1/2 | ZMP075212 | 135 | 188,5 | 147 | 33,5 | 24 | - |
| 75 | 3 | ZMP075300 | 135 | 191 | 147 | 32,5 | 24 | - |
| 90 | 2 | ZMP090200 | 158 | 217 | 177 | 31 | 16 | - |
| 90 | 2 1/2 | ZMP090212 | 158 | 220 | 177 | 33,5 | 14 | - |
| 90 | 3 | ZMP090300 | 158 | 222,5 | 177 | 36,5 | 14 | - |
| 90 | 4 | ZMP090400 | 158 | 228 | 177 | 43 | 14 | - |
| 110 | 2 | ZMP110200 | 191 | 252 | 210 | 31 | 8 | - |
| 110 | 3 | ZMP110300 | 191 | 259 | 210 | 36,5 | 8 | - |
| 110 | 4 | ZMP110400 | 191 | 264,5 | 210 | 43 | 6 | - |

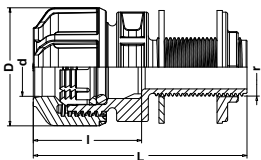

3GZASP

TANK CONNECTOR

| d | r | Code | DIMENSIONS | | | Box qty | Bag qty |
|----|------|---------------------|------------|-----|----|---------|---------|
| | | | D | L | l | | |
| 25 | 3/4" | 3GZASPO25034 | 55 | 109 | 53 | 60 | 10 |
| 32 | 1" | 3GZASPO32100 | 67 | 117 | 60 | 50 | 5 |

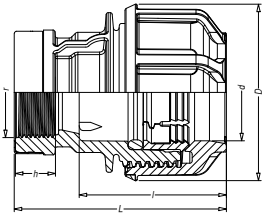

3GZFP / 3GZFKP

FEMALE ADAPTOR

| d | r | Code | DIMENSIONS | | | | Box qty | Bag qty |
|-----|-------|---------------------|------------|-------|------|------|---------|---------|
| | | | D | L | l | h | | |
| 16 | 1/2 | 3GZFP016012 | 39,5 | 62 | 38 | 22,8 | 80 | 10 |
| 20 | 1/2 | 3GZFP020012 | 46,5 | 67 | 47,3 | 17,7 | 230 | 10 |
| 20 | 3/4 | 3GZFP020034 | 46,5 | 67 | 47,3 | 17,7 | 220 | 10 |
| 20 | 1 | 3GZFP020100 | 46,5 | 73 | 44 | 27,4 | 120 | 10 |
| 25 | 1/2 | 3GZFP025012 | 55 | 72 | 50,5 | 17,7 | 150 | 10 |
| 25 | 3/4 | 3GZFP025034 | 55 | 72,5 | 52,8 | 17,7 | 150 | 10 |
| 25 | 1 | 3GZFP025100 | 55 | 80 | 52,5 | 20,7 | 130 | 10 |
| 32 | 3/4 | 3GZFP032034 | 67 | 88 | 63 | 17,5 | 80 | 5 |
| 32 | 1 | 3GZFP032100 | 67 | 88 | 64,3 | 20,4 | 80 | 5 |
| 40 | 1 | 3GZFP040100 | 82 | 102 | 73,5 | 20,6 | 60 | - |
| 40 | 1 1/4 | 3GZFKP040114 | 82 | 100 | 73,5 | 23,2 | 50 | - |
| 40 | 1 1/2 | 3GZFKP040112 | 82 | 101 | 71 | 30,2 | 50 | - |
| 50 | 1 1/4 | 3GZFKP050114 | 94 | 111 | 77,5 | 23 | 40 | - |
| 50 | 1 1/2 | 3GZFKP050112 | 94 | 111 | 77,5 | 23 | 35 | - |
| 50 | 2 | 3GZFKP050200 | 94 | 107 | 83 | 34,5 | 35 | - |
| 63 | 2 | 3GZFKP063200 | 109 | 131,5 | 93,8 | 27,4 | 20 | - |
| 75 | 2 | ZFP075200 | 135 | 186,5 | 147 | 32,5 | 28 | - |
| 75 | 2 1/2 | ZFP075212 | 135 | 187 | 147 | 32,5 | 20 | - |
| 90 | 2 | ZFP090200 | 158 | 217,5 | 177 | 32,5 | 16 | - |
| 90 | 3 | ZFP090300 | 158 | 222 | 177 | 36,5 | 14 | - |
| 90 | 4 | ZFP090400 | 158 | 236 | 177 | 43,5 | 14 | - |
| 110 | 3 | ZFP110300 | 191 | 256 | 210 | 35,5 | 10 | - |
| 110 | 4 | ZFP110400 | 191 | 263,5 | 210 | 43,5 | 10 | - |

From r1 1/4" to 4" provided of stainless steel reinforcing ring as standard, available on request the whole range with or without reinforcing ring

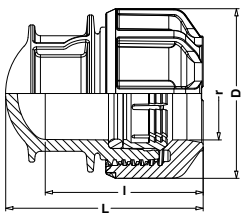

3GZCP

END CAP

| d | Code | DIMENSIONS | | | Box qty | Bag qty |
|-----|-----------------|------------|------|-----|---------|---------|
| | | D | L | l | | |
| 16 | 3GZCP016 | 39,5 | 50 | 40 | 100 | - |
| 20 | 3GZCP020 | 46,5 | 58,4 | 50 | 250 | 10 |
| 25 | 3GZCP025 | 55 | 70,2 | 60 | 160 | 10 |
| 32 | 3GZCP032 | 67 | 80 | 70 | 100 | 5 |
| 40 | 3GZCP040 | 82 | 95 | 83 | 55 | - |
| 50 | 3GZCP050 | 94 | 108 | 89 | 35 | - |
| 63 | 3GZCP063 | 109 | 127 | 102 | 20 | - |
| 75 | ZCP075 | 135 | 172 | 147 | 27 | - |
| 90 | ZCP090 | 158 | 207 | 177 | 10 | - |
| 110 | ZCP110 | 191 | 246 | 210 | 6 | - |