

# MAGNUM 3G

## d.16-63mm

Series of fittings with internal components mechanically retained together (into the body) in order to avoid any possible loss when installed, zero interference system to allow the free insertion to polyethylene pipes from d.16 up to d.63mm.

### “SLIDE & TIGHTEN” EXCLUSIVE EASY INSERTION & HYDRO MECHANICAL SEALING SYSTEM

**MAGNUM 3G** compression fittings make use of the “Slide & Tighten” low interference hydro-mechanical sealing system. This special system guarantees the insertion of pipes inside the fittings with very low manual effort and a complete operational safety. Once the pipe is inserted, the progressive tightening of the nut forces the pressure compressing the gasket, ensuring the water tight sealing and adjusting possible problems due to ovalized or under dimensioned pipes. The gasket functionality and the hydraulic sealing are preserve thanks to an appropriate compression.

## MAGNUM 3G

SYSTEM

### WORKING PRINCIPLE

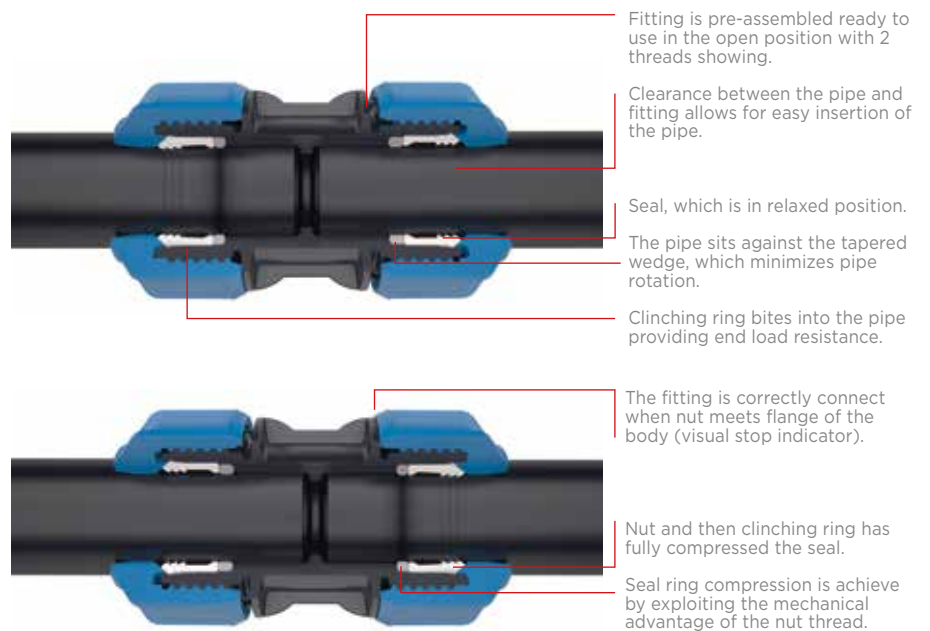

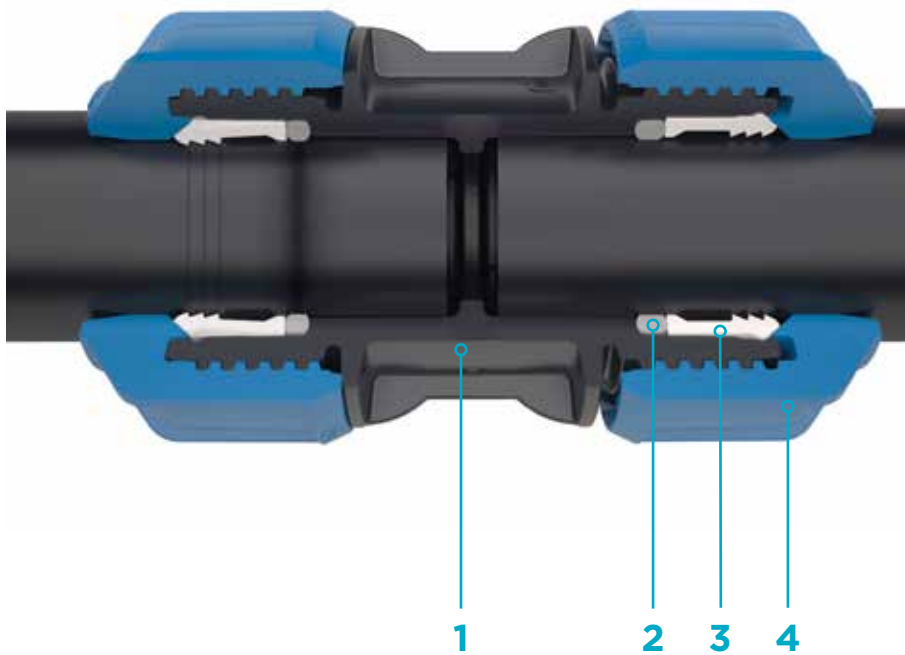

## 1 BODY

PP Copolymer  
 Drinking water compliance  
 Long Lifetime Mechanical  
 Resistance

## 2 SEAL RING

EPDM 70 Shore A  
 Drinking water approved

## 3 CLINCHING RING

Acetal (POM)  
 Long Lifetime Mechanical  
 Resistance

## 4 NUT

Acetal (POM)  
 Long Lifetime Mechanical  
 Resistance

# MAGNUM 3G LARGE BORE d.75-110mm

Series of fittings with internal components mechanically retained together (into the nut) in order to avoid any possible loss when installed, zero interference system to allow the free insertion to polyethylene pipes from d.75 to d.110mm.

## “SLIDE & TIGHTEN” EXCLUSIVE EASY INSERTION & HYDRO MECHANICAL SEALING SYSTEM

The **MAGNUM 3G** large bore series combines the **Slide & Tighten** hydro-mechanical sealing system with the special **NUT-IN** solution, which retains the sealing components within the nut. The dynamic sealing system is obtained by the special design of the compression chamber that guarantees a complete absence of interference between the pipe and the sealing gasket.

This technical feature allows the free insertion of pipes and reduces the installation times. Once the pipe is inserted, tightening progressively the ring nut up to the last thread, the pressure bush forces the gasket to its final appropriate compression chamber. When functioning under pressure, the clinching ring detaches from the pressure bush to reach the correct working position even during very critical laying conditions.

**MAGNUM 3G** system with makes your life easy: no need to dismantle the fitting to install or uninstall, and all the components remains into the nut. Thanks to this high integrity, there are no falling parts from the fitting during the hand managements.

**MAGNUM 3G**  
SYSTEM

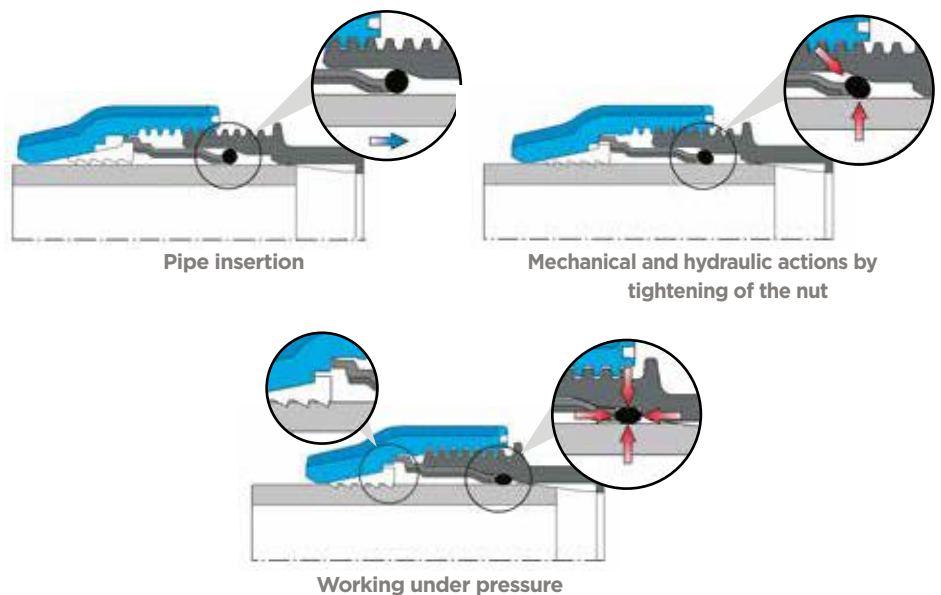

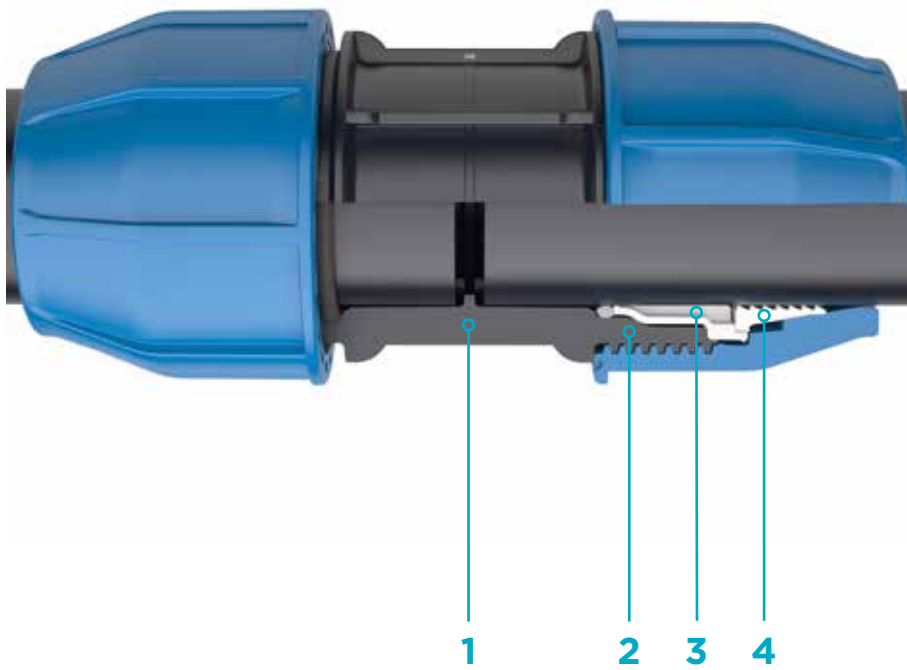

**1** BODY IN PP-B

**2** COMPRESSION  
CHAMBER AND  
GASKET

**3** PRESSER BUSH IN  
PP-B

**4** CLINCHING RING  
IN POM

# MAGNUM 3G d. 16-63 mm

## INSTALLATION INSTRUCTIONS

### 1. Cut Pipe Square

Cut the pipe square. There is no need to prepare the pipe end, check the pipe is free from foreign material or burrs. Chamfering or lubrication is not required.

### 2. Ready to Use Position

The fitting is pre-assembled and ready to use, however always ensure the nut is fully relaxed, 2 threads are showing before inserting the pipe.

### 3. Pipe Insertion

Insert the pipe until resistance is felt. Do not force the pipe.

### 4. Nut Tightening

Tighten the nut by hand and then firmly with a wrench. Tighten the nut until it just touches the body stop end (visual indicator).

### 5. Check for Correct Installation

Ensure the nut is tighten and no gap exists from the nut end to the compression fitting body stop end (visual indicator). Now the fitting is correctly install. **Make sure do not over tighten nut after reaching the body flange.**

### 6. Disassembly

To disassemble the fitting, simply loosen the nut using a wrench until 2 threads are showing. Pipe will be free, and can be simply pull out of the fitting.

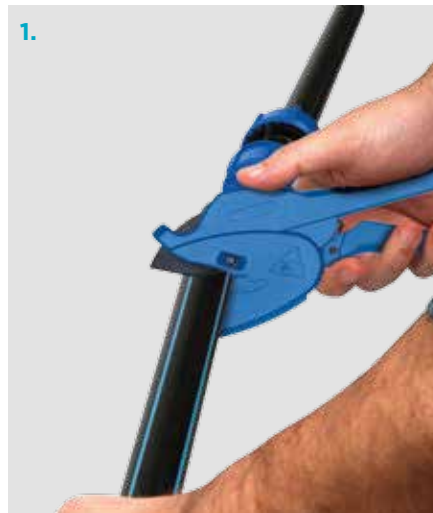

# MAGNUM 3G d. 75-110 mm INSTALLATION INSTRUCTIONS



## 1. Cut Pipe Square

Clean the pipe end and ensure it is free from burrs. Chamfering or lubrication of pipe is not required.



## 2. Ready to Use Position

The fitting is pre-assembled and ready to use, however always ensure that 3 threads are showing before proceeding.



## 3. Witness Mark the Pipe

In the ready to use position lay the pipe against the fitting with the end of the pipe lined up with the flange of the body. Witness mark the section of pipe that is long side the nut opening.



## 4. Pipe Insertion

Insert the pipe up to the witness mark, or if not using a witness mark until the first point of resistance is felt.



## 5. Nut Tightening

Tighten the nut by hand and then firmly with a wrench.



## 6. Fully Installed

Now the fitting is correctly install.



# THREADED FITTINGS INSTALLATION INSTRUCTIONS

**MAGNUM 3G** compression fittings offers a range of advantages over metal threaded fittings

- **Faster, Easier and Reliable Installation.**
- **Less Effort through lower friction**
- **Exploits the properties of Polypropylene to reduce the installation effort compared to metal threads**

**MAGNUM 3G threaded fitting bodies are molded with high performance engineering plastic material, which delivers significant benefits.**

**Less Friction**  
**MAGNUM 3G** threaded fittings require significantly less effort to install. The use of high performance plastic that provide far less friction than metal/metal threads.

**New Approach to Installation**  
**MAGNUM 3G** fittings drives in a new era of threaded connection. The high performance materials conform to slight irregularities in metal threads, whereas metal/metal connections tend to bind themselves by increasing the installation effort.

**Smaller Lighter tools**  
A simple set of multi-grip pliers has be used to install a **MAGNUM 3G** threaded fitting. No need to use a large wrench to install and tighten a threaded fitting.

**Proven Performance**  
**MAGNUM 3G** threaded fittings are built tough and are used worldwide by water companies, civil contractors, plumbers and in irrigation applications.

## Example - Male Adapter into a metal valve

1. Apply PTFE tape or suitable sealant to the plastic thread a quantity to ensure a watertight seal.
2. Using hand, screw the thread of the Male Adapter into the valve until firm.
3. Grip the body of the **MAGNUM 3G** fitting with Multi-grips or similar plumbing tools and continue to screw the male adapter into the valve until tight. Stop if the shoulder of the **MAGNUM 3G** fittings touches the valve.

**Note:** It is recommend the use of PTFE tape on threads to ensure a positive seal. If a liquid or paste sealant is used, ensure it is suitable to be use with material of **MAGNUM 3G** and the material connected to the fitting.



# DIMENSIONS

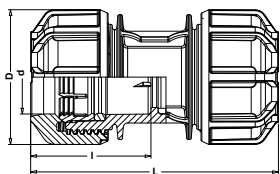

## 3GZBP

COUPLING

d	Code	DIMENSIONS			Box qty	Bag qty
		D	L	l		
16	<b>3GZBP016</b>	39,5	75	36,2	80	10
20	<b>3GZBP020</b>	46,5	89	43,4	150	10
25	<b>3GZBP025</b>	55	94	45,7	100	10
32	<b>3GZBP032</b>	67	117,6	57,5	65	5
40	<b>3GZBP040</b>	82	139	67	35	-
50	<b>3GZBP050</b>	94	160,6	79	24	-
63	<b>3GZBP063</b>	109	187	90,5	12	-
75	<b>ZBP075</b>	135	298	147	12	-
90	<b>ZBP090</b>	158	359	177	8	-
110	<b>ZBP110</b>	191	425,5	210	4	-

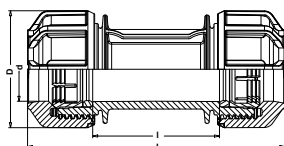

## 3GZRP

SLIP COUPLING

d	Code	DIMENSIONS			Box qty	Bag qty
		D	L	l		
20	<b>3GZRP020</b>	46,5	103,5	45,6	130	10
25	<b>3GZRP025</b>	55	121	51,3	70	10
32	<b>3GZRP032</b>	67	153,6	71,4	60	5
40	<b>3GZRP040</b>	82	188,5	97	30	-
50	<b>3GZRP050</b>	94	205	100,2	20	-
63	<b>3GZRP063</b>	109	221	106	12	-



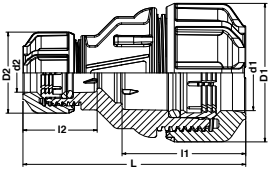

## 3GZBRP

REDUCING COUPLING

d1	d2	Code	DIMENSIONS					Box qty	Bag qty
			D1	D2	L	l1	l2		
20	16	<b>3GZBRP020016</b>	46,5	39,5	83	46	38	80	10
25	16	<b>3GZBRP025016</b>	55	39,5	87	51	38	120	10
25	20	<b>3GZBRP025020</b>	55	46,5	94	51	46	120	10
32	20	<b>3GZBRP032020</b>	67	46,5	110	60	46	80	5
32	25	<b>3GZBRP032025</b>	67	55	108	60	51	70	5
40	25	<b>3GZBRP040025</b>	82	55	125	71	51	50	-
40	32	<b>3GZBRP040032</b>	82	67	128	71	60	40	-
50	25	<b>3GZBRP050025</b>	94	55	141	83	51	30	-
50	32	<b>3GZBRP050032</b>	94	67	150	83	60	30	-
50	40	<b>3GZBRP050040</b>	94	82	149	83	71	25	-
63	32	<b>3GZBRP063032</b>	109	67	167	93	60	20	-
63	40	<b>3GZBRP063040</b>	109	82	173	93	71	18	-
63	50	<b>3GZBRP063050</b>	109	94	174	93	83	16	-
75	63	<b>ZBRP075063</b>	135	113	275	147	124	20	-
90	75	<b>ZBRP090075</b>	158	135	329	177	147	12	-
110	90	<b>ZBRP110090</b>	191	158	392,5	210	177	6	-

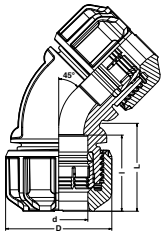

## 3GZHP

45° ELBOW

d	Code	DIMENSIONS			Box qty	Bag qty
		D	L	l		
32	<b>3GZHP032</b>	67	53	52	20	5
40	<b>3GZHP040</b>	82	67	66	15	-
50	<b>3GZHP050</b>	94	81	71	20	-
63	<b>3GZHP063</b>	109	97	82	12	-

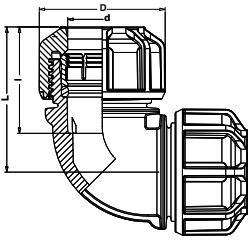

## 3GZGP

90° ELBOW

d	Code	DIMENSIONS			Box qty	Bag qty
		D	L	I		
16	<b>3GZGP016</b>	39,5	51	38,5	80	10
20	<b>3GZGP020</b>	46,5	57	44,5	140	10
25	<b>3GZGP025</b>	55	66,5	49,5	90	10
32	<b>3GZGP032</b>	67	77	58	50	5
40	<b>3GZGP040</b>	82	91	71	30	-
50	<b>3GZGP050</b>	94	102,5	76	18	-
63	<b>3GZGP063</b>	109	119,5	88,5	10	-
75	<b>ZGP075</b>	135	191	147	12	-
90	<b>ZGP090</b>	158	227	177	5	-
110	<b>ZGP110</b>	191	270,5	210	4	-

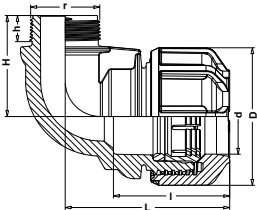

## 3GZGMP

MALE THREADED 90° ELBOW

d	r	Code	DIMENSIONS					Box qty	Bag qty
			D	L	I	H	h		
16	1/2	<b>3GZGMP016012</b>	39,5	50,8	38	37,3	16,8	80	10
20	1/2	<b>3GZGMP020012</b>	46,5	58,7	43,9	38,8	16,8	220	10
20	3/4	<b>3GZGMP020034</b>	46,5	58,7	43,9	62,8	16,8	190	10
25	1/2	<b>3GZGMP025012</b>	55	64,7	49,7	43,4	16,8	150	10
25	3/4	<b>3GZGMP025034</b>	55	65,6	49,7	43,4	16,8	120	10
25	1	<b>3GZGMP025100</b>	55	67,8	49	50,1	19,4	110	10
32	3/4	<b>3GZGMP032034</b>	67	80,2	57,9	48,9	16,6	75	5
32	1	<b>3GZGMP032100</b>	67	80,2	58,4	51,4	18,4	75	5
32	1 1/4	<b>3GZGMP032114</b>	67	82	58,7	54,7	20,5	75	5
40	1	<b>3GZGMP040100</b>	82	95,8	67,6	58,6	18,4	45	-
40	1 1/4	<b>3GZGMP040114</b>	82	96,4	68,6	60,9	20,7	45	-
50	1 1/4	<b>3GZGMP050114</b>	94	111,2	79,2	68	21	30	-
50	1 1/2	<b>3GZGMP050112</b>	94	112	79,2	68	21	30	-
63	2	<b>3GZGMP063200</b>	109	129,5	88,8	79,5	24,5	18	-

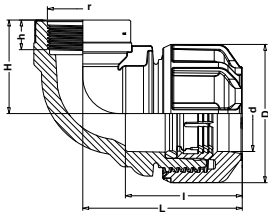

## 3GZGFP / 3GZGFKP

90° ELBOW FEMALE THREADED

d (mm)	r (inches)	Code	DIMENSIONS					Box qty	Bag qty
			D	L	I	H	h		
16	1/2"	<b>3GZGFP016012</b>	39,5	51	38	67	22,8	80	10
20	1/2	<b>3GZGFP020012</b>	46,5	58,8	40,6	32,8	17,7	230	10
20	3/4	<b>3GZGFP020034</b>	46,5	58,8	40,6	34,5	18,4	190	10
25	1/2	<b>3GZGFP025012</b>	55	70,4	50,5	34,9	17,6	150	10
25	3/4	<b>3GZGFP025034</b>	55	70,4	50,5	36,8	17,6	120	10
25	1	<b>3GZGFP025100</b>	55	70,4	50,5	42,3	21	110	10
32	3/4	<b>3GZGFP032034</b>	67	82,6	58	41,7	17,7	75	5
32	1	<b>3GZGFP032100</b>	67	81,8	58	44,1	20,9	75	5
32	1 1/4	<b>3GZGFKP032114</b>	67	82,8	58	48,7	23,6	75	5
40	1	<b>3GZGFP040100</b>	82	98,1	70,2	49,8	21	45	-
40	1 1/4	<b>3GZGFKP040114</b>	82	97,4	70,2	52,1	23,3	45	-
50	1 1/4	<b>3GZGFKP050114</b>	94	106,7	78,5	61,5	23,3	30	-
50	1 1/2	<b>3GZGFKP050112</b>	94	107,6	78,5	61,5	23,3	30	-
50	2	<b>3GZGFKP050200</b>	94	106	83	142	34,5	26	-
63	2	<b>3GZGFKP063200</b>	109	119,8	85,4	77,5	28	18	-
75	2	<b>ZGFP075200</b>	135	191	147	99	32,5	20	-
75	2 1/2	<b>ZGFP075212</b>	135	191	147	99	32,5	14	-
75	3	<b>ZGFP075300</b>	135	191	147	129	36,5	14	-
90	3	<b>ZGFP090300</b>	158	158	177	123	36,5	10	-
110	4	<b>ZGFP110300</b>	191	191	210	144	43,5	6	-

From r.1 1/4" to 4" provided of stainless steel reinforcing ring as standard, available on request the whole range with or without reinforcing ring

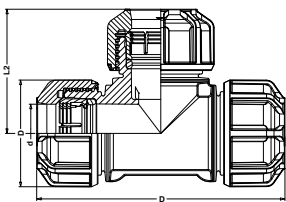

## 3GZTP

TEE 90°

d	Code	DIMENSIONS				Box qty	Bag qty
		D	L	L2	I		
16	<b>3GZTP016</b>	39,5	102	51	36	50	10
20	<b>3GZTP020</b>	46,5	117,5	58,3	44	90	10
25	<b>3GZTP025</b>	55	130,7	63,8	48,2	50	10
32	<b>3GZTP032</b>	67	154,3	78,4	57,4	30	5
40	<b>3GZTP040</b>	82	184,5	93,1	65,3	18	-
50	<b>3GZTP050</b>	84	210	104	75	12	-
63	<b>3GZTP063</b>	109	242	115	82,7	8	-
75	<b>ZTP075</b>	135	382	188	147	6	-
90	<b>ZTP090</b>	158	454	226	177	3	-
110	<b>ZTP110</b>	191	541	276	210	2	-

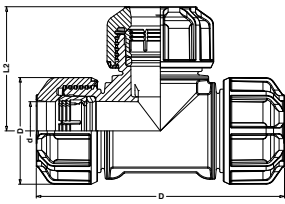

## 3GZTRRP

SLIP TEE 90°

d	Code	DIMENSIONS			Box qty	Bag qty
		D	L	L2		
20	<b>3GZTRRP020</b>	46,5	117	59	90	10
25	<b>3GZTRRP025</b>	55	134	67	50	10
32	<b>3GZTRRP032</b>	67	160	80	25	5
40	<b>3GZTRRP040</b>	82	182	95	18	-
50	<b>3GZTRRP050</b>	84	202	101	10	-
63	<b>3GZTRRP063</b>	109	236	118	7	-

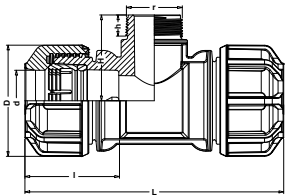

## 3GZTMP

TEE 90° MALE THREADED

d	r	Code	DIMENSIONS					Box qty	Bag qty
			D	L	l	H	h		
25	1/2	<b>3GZTMP025012</b>	55	114	39,5	53	19,8	80	10
25	3/4	<b>3GZTMP025034</b>	55	114	39,5	54	21,1	75	5
32	1	<b>3GZTMP032100</b>	67	158,5	60	54,4	18,6	50	-
40	1 1/4	<b>3GZTMP040114</b>	82	191	68	63,4	19,5	25	-
50	1 1/2	<b>3GZTMP050112</b>	94	218	79	72	19,5	18	-
63	2	<b>3GZTMP063200</b>	109	245	85	86,5	21,9	10	-

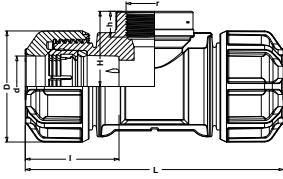

## 3GZTFP / 3GZTFKP

TEE 90° FEMALE THREADED

d	r	Code	DIMENSIONS						Box qty	Bag qty
			D	L	l	H	h			
16	1/2	3GZTFP016012	39,5	102	36	33	22,8	60	10	
20	1/2	3GZTFP020012	46,5	120	44,8	31,8	17,4	110	10	
20	3/4	3GZTFP020034	46,5	120	44,8	34,8	17,6	110	10	
25	1/2	3GZTFP025012	55	134	50,6	37,5	17,5	70	10	
25	3/4	3GZTFP025034	55	134	50,6	37,5	17,7	60	10	
25	1	3GZTFP025100	55	134	50,6	43	20,7	60	10	
32	3/4	3GZTFP032034	67	162	60	43,3	17,5	45	5	
32	1	3GZTFP032100	67	162	60	46,9	20,9	40	5	
32	1 1/4	3GZTFKP032114	67	162	60	49,9	23	40	5	
40	1	3GZTFP040100	82	192	68,3	53	21	20	-	
40	1 1/4	3GZTFKP040114	82	192	68,3	53	23,5	20	-	
50	1 1/4	3GZTFKP050114	94	218	79	60,5	23,6	15	-	
50	1 1/2	3GZTFKP050112	94	218	79	62,5	23,6	15	-	
63	2	3GZTFKP063200	109	241	84,8	76,5	27,6	9	-	
75	2	ZTFP075200	135	382	147	76,5	32,5	8	-	
75	2 1/2	ZTFP075212	135	382	147	76	32,5	8	-	
75	3	ZTFP075300	135	382	147	92,5	36,5	8	-	
90	3	ZTFP090300	158	454	177	86,5	36,5	4	-	
110	4	ZTFP110400	191	541	210	101,5	43,5	3	-	

From r1 1/4" to 4" provided of stainless steel reinforcing ring as standard, available on request the whole range with or without reinforcing ring

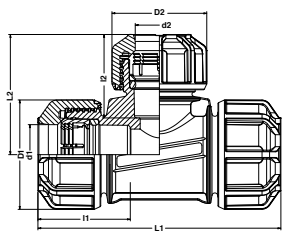

## 3GZTRP

REDUCING TEE 90°

d1	d2	Code	DIMENSIONS							Box qty	Bag qty
			D1	L1	l1	D2	L2	l2			
25	20	3GZTRP025020	55	134	50	47	64	45,5	60	10	
25	32	3GZTRP025032	55	134	50	67	69	62	55	5	
32	25	3GZTRP032025	67	160	60	55	74	51	35	5	
40	25	3GZTRP040025	81	166	71	55	74	51	20	-	
40	32	3GZTRP040032	81	171	71	67	84	60	20	-	
50	25	3GZTRP050025	94	182	79	55	81	51	12	-	
50	32	3GZTRP050032	94	187	79	67	90	63	12	-	
50	40	3GZTRP050040	94	197	79	81	98	71	12	-	
63	25	3GZTRP063025	110	196	88	55	88	51	9	-	
63	32	3GZTRP063032	110	201	88	67	98	59	9	-	
63	50	3GZTRP063050	110	220	88	94	111	79	9	-	

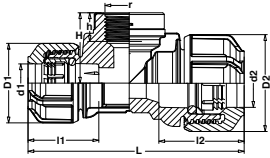

### 3GZTFP

TEE 90° FEMALE THREADED

d1	r	d2	Code	DIMENSIONS						Box qty	Bag qty	
				D1	D2	L	l1	l2	H			h
25	1	32	<b>3GZTFP03210005</b>	55	67	152	50,3	60	48	20,2	60	10

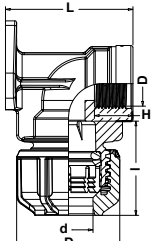

### 3GZWFP

WALL PLATE ELBOW 90°

d	r	Code	DIMENSIONS				Box qty	Bag qty
			D	L	l	h		
20	1/2"	<b>3GZWFP020012</b>	46,5	56	44,5	20,8	230	10
25	3/4"	<b>3GZWFP025034</b>	55	65	51,2	20,8	120	10

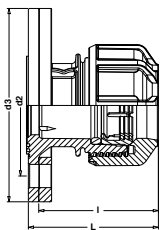

### 3GZOP

FLANGED ADAPTOR

d1	DN	Code	DIMENSIONS						Box qty	Bag qty
			D	d2	d3	L	l			
50	40	<b>3GZOP050040</b>	94	109,5	149,2	102	92	18	-	
50	50	<b>3GZOP050050</b>	94	124,6	164,3	102	92	18	-	
63	50	<b>3GZOP063050</b>	109	124,6	164,3	112	102	10	-	
75	75	<b>ZOP075065</b>	75	145	185	165	147	10	-	
90	80	<b>ZOP090080</b>	90	160	200	197	177	6	-	
90	100	<b>ZOP090100</b>	90	180	220	198,5	177	6	-	
110	100	<b>ZOP110100</b>	110	180	220	231	210	5	-	



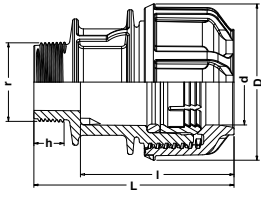

## 3GZMP

MALE ADAPTOR

d	r	Code	DIMENSIONS				Box qty	Bag qty
			D	L	l	h		
16	3/8	<b>3GZMP016038</b>	39,5	68	44	21,1	100	10
16	1/2	<b>3GZMP016012</b>	39,5	58	42,1	14,5	100	10
16	3/4	<b>3GZMP016034</b>	39,5	68	44	21,1	100	10
20	1/2	<b>3GZMP020012</b>	46,5	70,4	50,1	14,5	240	10
20	3/4	<b>3GZMP020034</b>	46,5	70,4	50,1	14,5	240	10
25	1/2	<b>3GZMP025012</b>	55	76,2	57,9	14,5	150	10
25	3/4	<b>3GZMP025034</b>	55	78,2	57,9	14,5	150	10
25	1	<b>3GZMP025100</b>	55	80,3	57,9	16,4	150	10
32	3/4	<b>3GZMP032034</b>	67	88,5	66	14,5	90	5
32	1	<b>3GZMP032100</b>	67	90,7	66	16,4	90	5
32	1 1/4	<b>3GZMP032114</b>	67	92,4	66	18,4	90	5
32	1 1/2	<b>3GZMP032112</b>	67	97	67,5	26,7	85	5
40	1	<b>3GZMP040100</b>	82	102,8	78,3	16,4	55	-
40	1 1/4	<b>3GZMP040114</b>	82	104,5	78,3	18,4	55	-
40	1 1/2	<b>3GZMP040112</b>	82	109	81	26,7	55	-
40	2	<b>3GZMP040200</b>	82	109	81	31	50	-
50	1 1/4	<b>3GZMP050114</b>	94	114,2	87,2	18,4	35	-
50	1 1/2	<b>3GZMP050112</b>	94	115	87,2	19	35	-
50	2	<b>3GZMP050200</b>	94	119	87,2	31	32	-
63	1 1/2	<b>3GZMP063112</b>	109	132	98,5	26,7	24	-
63	2	<b>3GZMP063200</b>	109	132	97	22,9	22	-
75	2	<b>ZMP075200</b>	135	187	147	32	24	-
75	2 1/2	<b>ZMP075212</b>	135	188,5	147	33,5	24	-
75	3	<b>ZMP075300</b>	135	191	147	32,5	24	-
90	2	<b>ZMP090200</b>	158	217	177	31	16	-
90	2 1/2	<b>ZMP090212</b>	158	220	177	33,5	14	-
90	3	<b>ZMP090300</b>	158	222,5	177	36,5	14	-
90	4	<b>ZMP090400</b>	158	228	177	43	14	-
110	2	<b>ZMP110200</b>	191	252	210	31	8	-
110	3	<b>ZMP110300</b>	191	259	210	36,5	8	-
110	4	<b>ZMP110400</b>	191	264,5	210	43	6	-

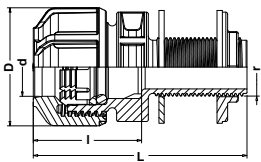

## 3GZASP

TANK CONNECTOR

d	r	Code	DIMENSIONS			Box qty	Bag qty
			D	L	l		
25	3/4"	<b>3GZASPO25034</b>	55	109	53	60	10
32	1"	<b>3GZASPO32100</b>	67	117	60	50	5

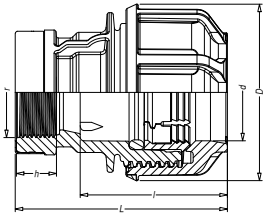

## 3GZFP / 3GZFKP

FEMALE ADAPTOR

d	r	Code	DIMENSIONS				Box qty	Bag qty
			D	L	l	h		
16	1/2	<b>3GZFP016012</b>	39,5	62	38	22,8	80	10
20	1/2	<b>3GZFP020012</b>	46,5	67	47,3	17,7	230	10
20	3/4	<b>3GZFP020034</b>	46,5	67	47,3	17,7	220	10
20	1	<b>3GZFP020100</b>	46,5	73	44	27,4	120	10
25	1/2	<b>3GZFP025012</b>	55	72	50,5	17,7	150	10
25	3/4	<b>3GZFP025034</b>	55	72,5	52,8	17,7	150	10
25	1	<b>3GZFP025100</b>	55	80	52,5	20,7	130	10
32	3/4	<b>3GZFP032034</b>	67	88	63	17,5	80	5
32	1	<b>3GZFP032100</b>	67	88	64,3	20,4	80	5
40	1	<b>3GZFP040100</b>	82	102	73,5	20,6	60	-
40	1 1/4	<b>3GZFKP040114</b>	82	100	73,5	23,2	50	-
40	1 1/2	<b>3GZFKP040112</b>	82	101	71	30,2	50	-
50	1 1/4	<b>3GZFKP050114</b>	94	111	77,5	23	40	-
50	1 1/2	<b>3GZFKP050112</b>	94	111	77,5	23	35	-
50	2	<b>3GZFKP050200</b>	94	107	83	34,5	35	-
63	2	<b>3GZFKP063200</b>	109	131,5	93,8	27,4	20	-
75	2	<b>ZFP075200</b>	135	186,5	147	32,5	28	-
75	2 1/2	<b>ZFP075212</b>	135	187	147	32,5	20	-
90	2	<b>ZFP090200</b>	158	217,5	177	32,5	16	-
90	3	<b>ZFP090300</b>	158	222	177	36,5	14	-
90	4	<b>ZFP090400</b>	158	236	177	43,5	14	-
110	3	<b>ZFP110300</b>	191	256	210	35,5	10	-
110	4	<b>ZFP110400</b>	191	263,5	210	43,5	10	-

From r1 1/4" to 4" provided of stainless steel reinforcing ring as standard, available on request the whole range with or without reinforcing ring

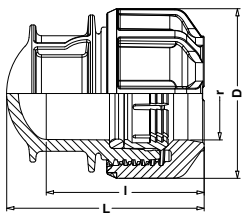

## 3GZCP

END CAP

d	Code	DIMENSIONS			Box qty	Bag qty
		D	L	l		
16	<b>3GZCP016</b>	39,5	50	40	100	-
20	<b>3GZCP020</b>	46,5	58,4	50	250	10
25	<b>3GZCP025</b>	55	70,2	60	160	10
32	<b>3GZCP032</b>	67	80	70	100	5
40	<b>3GZCP040</b>	82	95	83	55	-
50	<b>3GZCP050</b>	94	108	89	35	-
63	<b>3GZCP063</b>	109	127	102	20	-
75	<b>ZCP075</b>	135	172	147	27	-
90	<b>ZCP090</b>	158	207	177	10	-
110	<b>ZCP110</b>	191	246	210	6	-